

## SPACES IN BETWEEN

program:	public space, place making
location:	no fixed location / multiple locations
basics:	concrete rubble recycling, installation
area:	no fixed size
year:	2018; 2020
in team with:	-

Spaces In Between is a conceptual architectural project of public space and installation that operates as a social and cultural catalyst. Neutral like a "dark matter" space that doesn't interact with surroundings but has a strong influence on it. The installation has no fixed size, just proportions, and can be easily placed in any area. The installation can be built from recycling concrete adapting and demonstrating sustainability practices to the public.

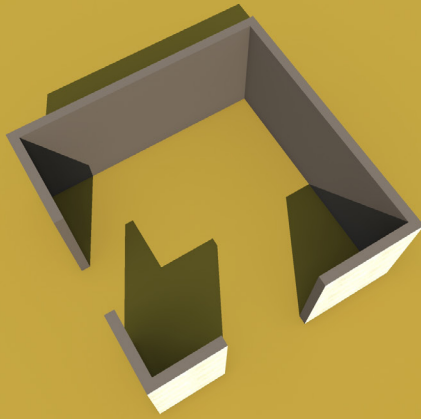



Where the void can still be preserved...  
Wasteland at Petra Sahaidachnoho Street / now pedestrian,.  
Kyiv, Ukraine  
Only one from various possible locations.

Public space is a void that manifests city ownership by its citizens. It's what adds value to the urban life-style. Unfortunately, in rapidly growing cities, voids can be lost. And the right for the city ownership as well.

In order to preserve the void, it can acquire a defined shape to manifest its existence.

spaces in [ ] brackets  
[ meeting point ]  
[ informal social dialogue ]  
[ cultural catalyst ]  
[ sub cultural retrieve ]



+  
+ free shape.  
free size.  
free placement.  
free interpretation.  
free from stereotypes.

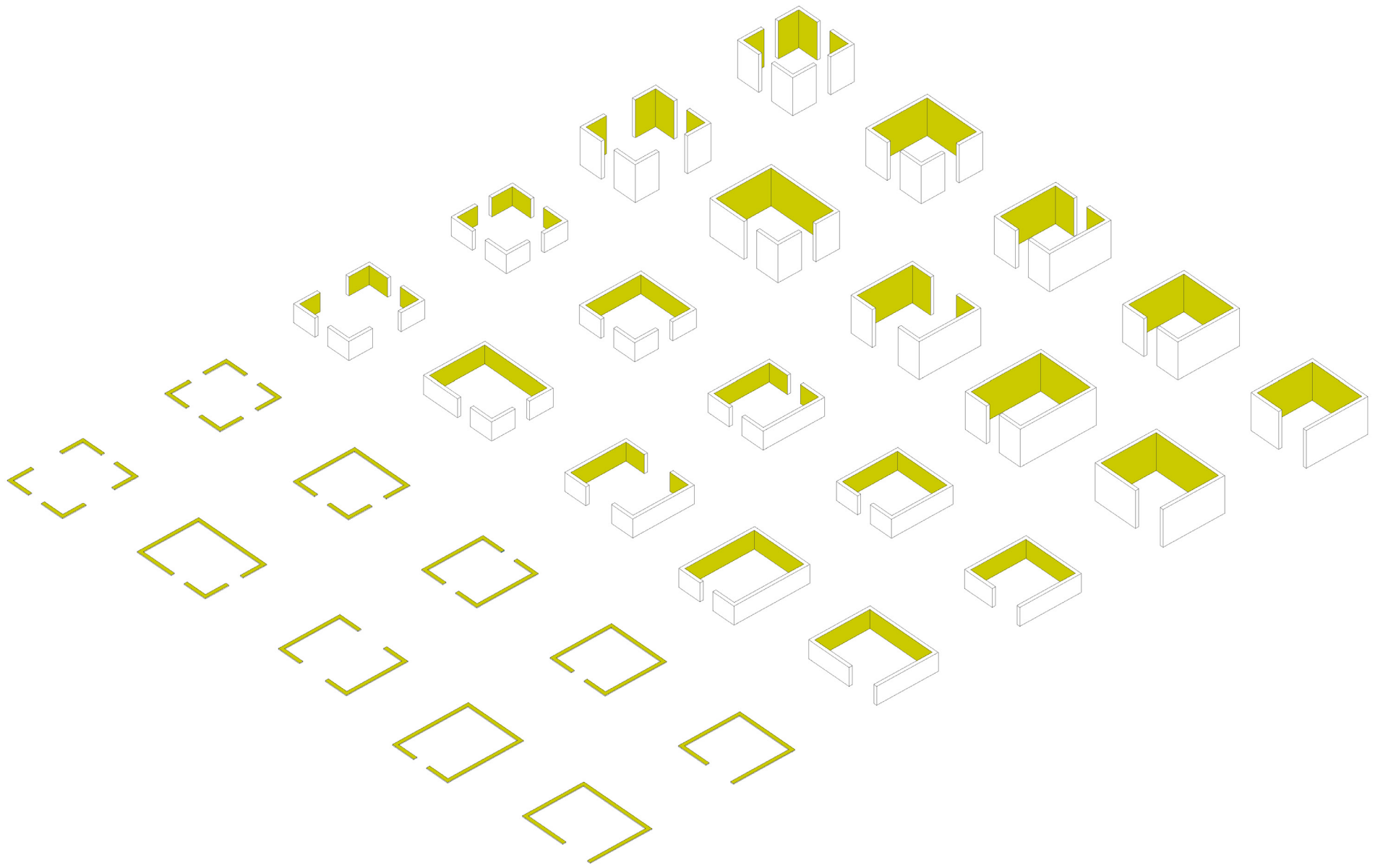



[ 2020 ]

2020 Pandemic revealed street, city and public space injustices all over the world even more. When artists, musicians, actors, dancers (you name it) cannot perform inside anymore, they were simply left out of jobs or to virtual space and social assistance in the best-case scenario. Whereas the physical space is still occupied by a “non-human user” - a car. With just a glance into google maps in North America, it's becoming clear that roughly 50% of the urban landscape is dedicated to a vehicle - whereas highway, road, or parking.

City, street and public space justice means that space is shared equally and serves a user most in need. It doesn't mean that streets and city space to be redesigned and changed drastically. It doesn't mean that we have to refuse cars. It means that the streets that we already have can become more resilient to the needs of actual citizens.



Ottawa, ON, Canada; an empty dead end near uOttawa.  
Random location.